

Centro

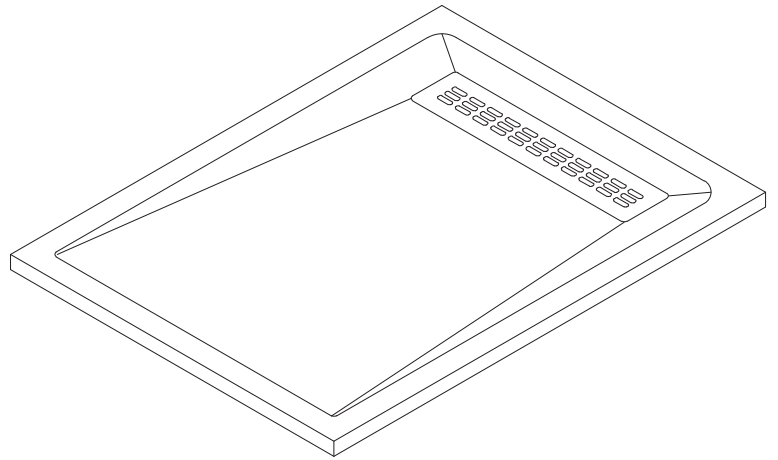

Linea



Granite • Quartz • Shower Bases

Installation Guide

Roc-Base

support@rocbase.com
rocbase.com

386 rue Principale
Saint-Sebastien, QC
G0Y 1M0
Canada

Be sure to read all the instructions carefully before starting the installation of a Roc-Base. Two person installation is required.

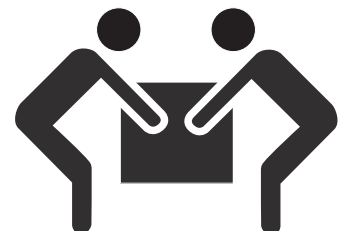

Before you start :

Be sure to read all instructions. Have all the tools in hand.

For all technical questions:
support@roc-base.com

Warning

- Make sure that no screw heads protrude from the floor
- Make sure to protect surface of the Roc-Base during the work to avoid damaging it.
- Make sure that the drain and the shower head are not directly above each other (to prevent odor return)

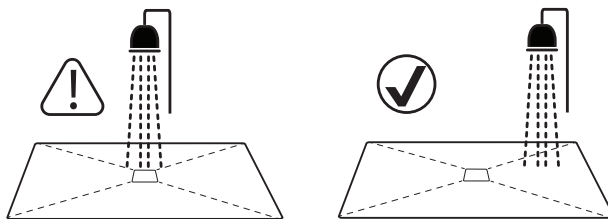

Included with the Roc-Base

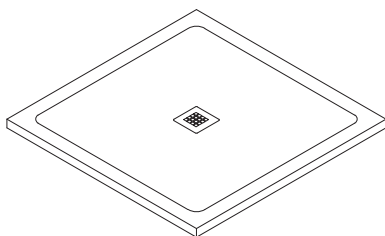

Roc-Base



Grid

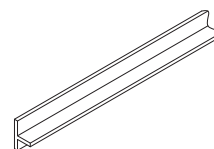

Tile Flange

Required tools (not included)

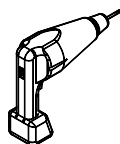

Drill



Silicone

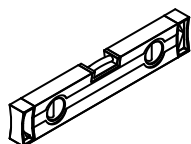

Level

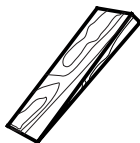

Shim

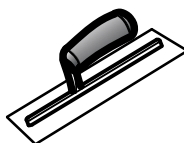

Trowel



Mortar

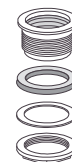

Complete Drain

Care and maintenance

Here are some basic recommendations so that you can enjoy your ROC-BASE shower base for many years to come.

Clean your shower base with a solution of lukewarm water with a mild soap, gently scrub with a scouring pad or non-abrasive brush, then rinse with clean water.

Warning :

Certain products with a higher PH level can damage the surface finish of your base and reduce its waterproofness.

The use of the products below is strongly discouraged.

Cleaners such as:

Mr. Clean
Scrubbing Bubble
Fantastik
Hertel
Vim
Pine Sol

Scouring powders such as:

Cornet
Ajax
Old Dutch

Water repellent sealant

ROC-BASE granite bases receive a water repellent treatment at the factory and do not require any subsequent treatment.

Quartz ROC-BASE bases do not require any repellent treatment as quartz is an agglomerated product containing a polymer resin.

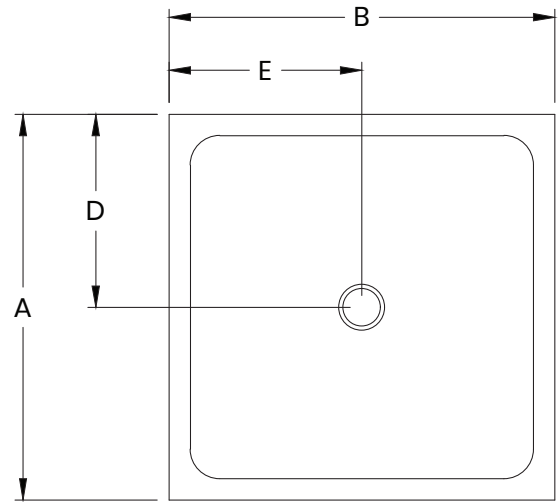
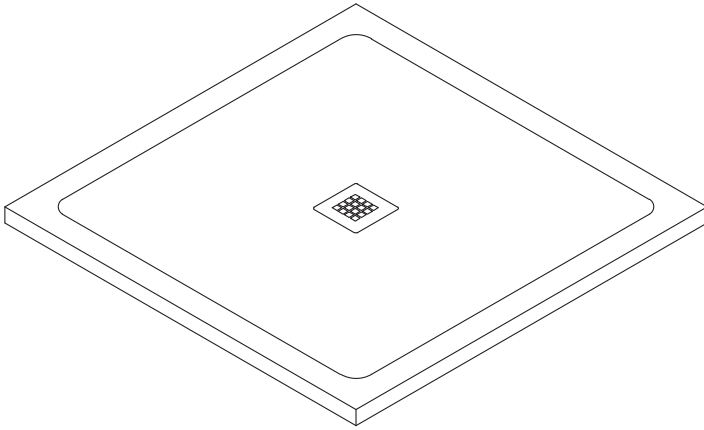

C = Thickness

Centro					
Model	Dimensions				
	A	B	C	D	E
3636	36"	36"	1 ¼"	18"	18"
3648	36"	48"	1 ¼"	18"	24"
3660	36"	60"	1 ¼"	18"	30"
6032	32"	60"	1 ¼"	16"	30"
6042	42"	60"	1 ¼"	21"	30"

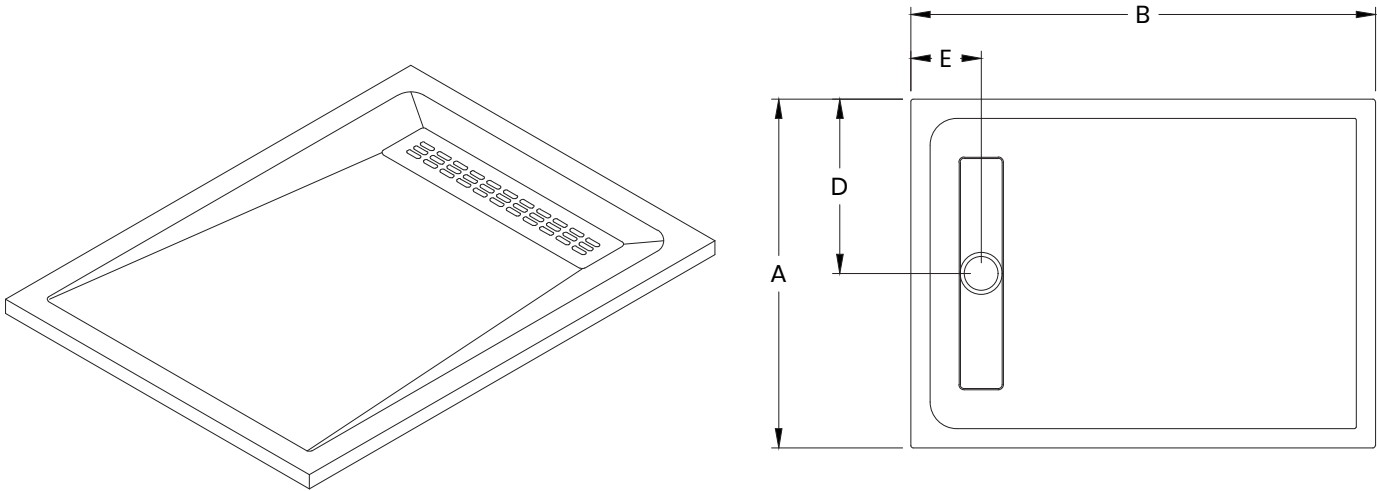

C = Thickness

Linea					
Model	Dimensions				
	A	B	C	D	E
3648	36"	48"	1 ¼	18	7 ¼
3660	36"	60"	1 ¼	18	7 ¼
6032	32	60	1 ¼	16	7 ¼
6042	42	60	1 ¼	21	7 ¼

1 Drill a ± 6 inch. diameter hole in the floor for the drain.

Drill a ± 6 inch. diameter hole in the floor for the drain.

The 2" evacuation pipe must be level with the existing floor. Refer to the specification chart for dimensions D and E.

If you do not have easy access by the bottom you need to assemble the drain on the base prior to gluing.

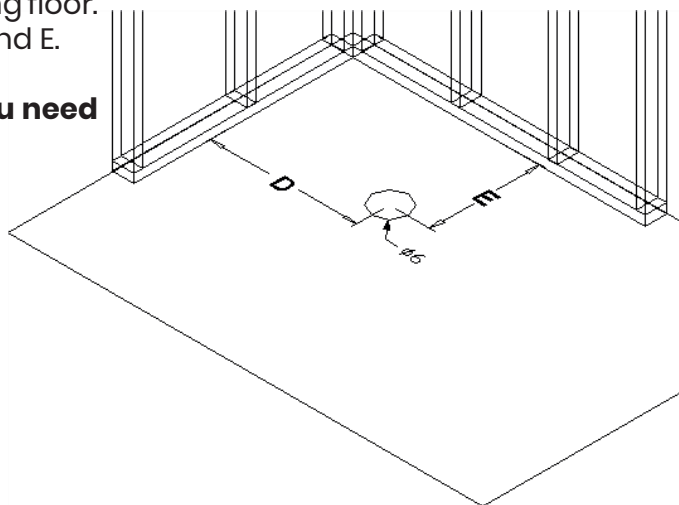

1 B - Radiant floor heating

In the case of a floor with radiant heating, leave a **clearance of 6"** between the drain hole and the heating mat.

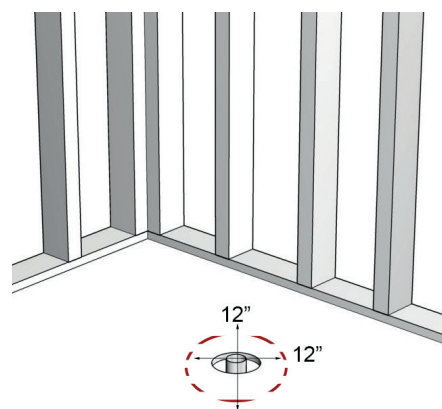

2 Install the drain cover

- Install the drain cover as shown.
- Apply silicone around the edge of the drain hole in the base (surface between the top part of the drain and the base).
- Insert the top part of the drain in the drain hole.
- Install rubber gasket then cardboard gasket on the top part of the drain coming out under the base.
- Screw bottom part of drain on top part of drain under the base.

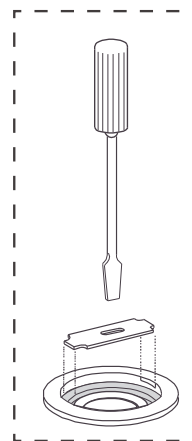
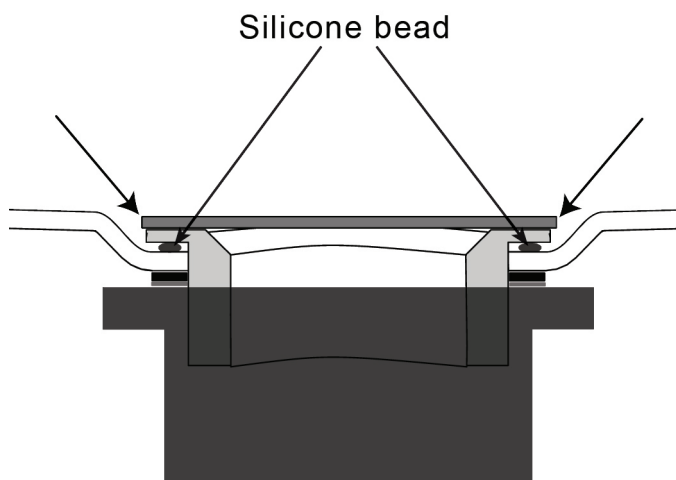
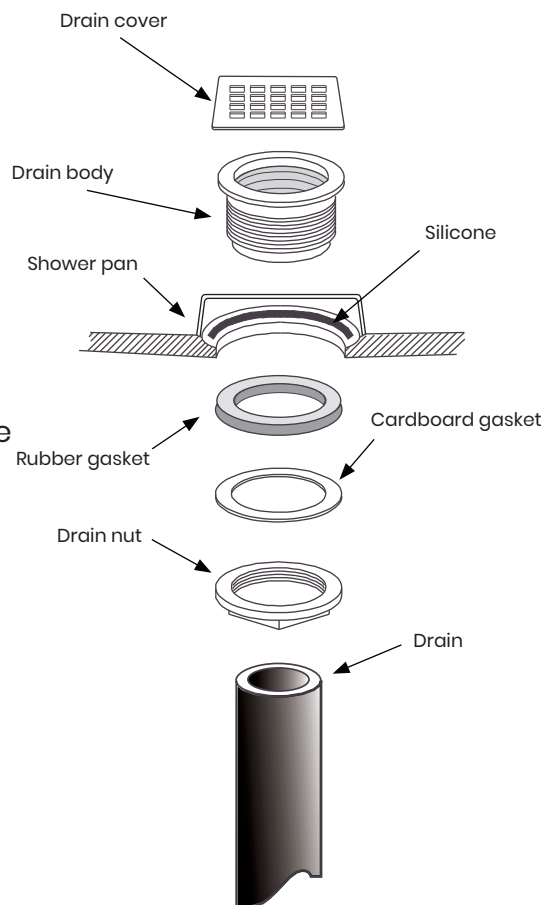

Use a screwdriver to tighten the body.
Be careful not to over tighten.

3 Put the base in place

Put the base in place. Check the level of the installations and the positioning of the plumbing (**DO NOT GLUE THE BASE AT THIS STEP**). Level the base perfectly using a spirit level. If necessary, insert small shims to adjust. Leave the shims in place and remove the base.

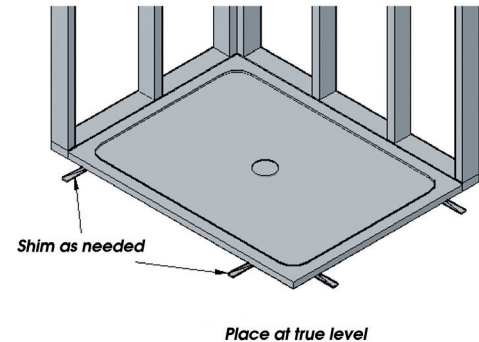

4 Apply the thin-set tile mortar

Apply the thin-set tile mortar to the floor according to manufacturer instructions. **BE CAREFUL NOT TO MOVE SHIMS.**

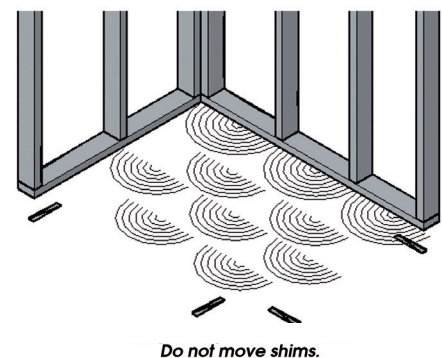

Centro / Linea

5 Install tile flanges

Apply a thin line of silicone to the base along the walls then place the tile flanges on the silicone and apply firmly to set in place.

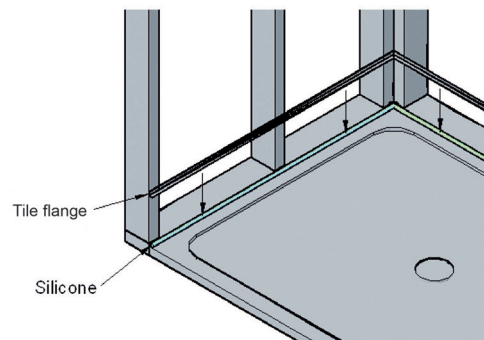

Centro / Linea

6 Apply silicone

Once the tile flanges are firmly in place, apply a thin coat of silicone at the junction of both ribs.

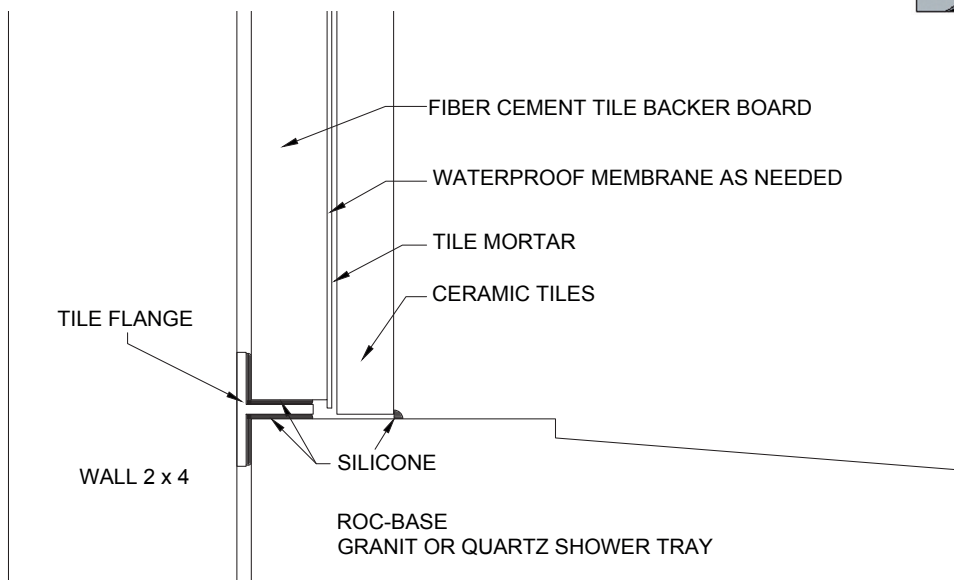
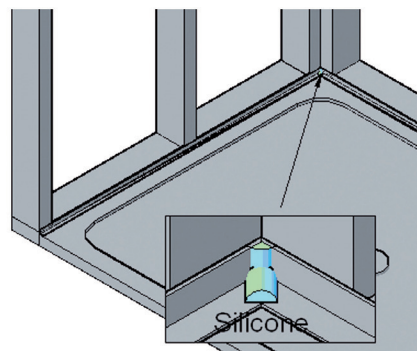

Limited Warranty

1. This warranty allows Roc-Base Inc., to either repair or replace the product in accordance with what is deemed the best solution for the defective product. This warranty applies to products sold by an authorized retailer.

2. This warranty does not cover labor and shipping charges, or damages whatever incurred in the whole or in part from installation, removal, re-installation, repair or replacement of any Roc-Base Inc. product or part, as well as any incidental or consequential damages, expenses, losses, direct or indirect, arising from any cause whatsoever.

3. The duration of the warranty is 5 years from the invoice or receipt date of the purchase or, if applicable, the delivery unless its date was after of the aforementioned documents. If the product was a display or demonstration model for the retailer the warranty will only be applicable for one year.

4. Roc-Base Inc. guarantees its products and components against any manufacturing defect, provided that they have been correctly installed (in compliance with the standard in force and the instructions indicated for their assembly, maintenance and conservation) and that they have been used correctly as their design intended.

5. Consumable articles (rubber elements, gaskets, etc.) are not covered by this warranty.

6. The following is excluded from this WARRANTY:

a. *Damage resulting from transport.*

b. *Damage resulting from incorrect installation, handling or repairs performed by individuals not authorized by Roc-Base Inc., as well as damage due to natural wear, poor treatment, and use and maintenance which is incorrect, unsuitable, abnormal or different from usual and/or to that indicated in the relevant instructions.*

c. *Damage caused by dirt, limescale and other physical, chemical or electrochemical defects.*

d. *Damage or loss sustained in any natural calamity such as earthquake, thunder, electrical storm, etc.*

e. *Damage which, viewed objectively, cannot be attributed to the manufacturer.*

f. *Check the dimensions, color, etc. of all shower bases prior to installation. No claims will be accepted for these reasons once installed.*

g. *In the case of shower bases, prior to completing the tiling and any other element on the shower bases, the installer must check the installation to verify that the base drains correctly. Should this not be done properly, Roc-Base, will not bear the costs resulting from replacing the elements on the bases such as shower screens or ceramics.*

7.

8. *This warranty is extended to the purchaser at a retailer and is not transferable. The original sales receipt must be available to exercise the warranty.*

9. *For any questions or warranty service requests, please contact Roc-Base Inc.*



Granite • Quartz • Shower Bases

by **Granit Plus**
GRANIT - QUARTZ COUNTERTOP - SINCE 1989