



Granite • Quartz • Shower Bases

877-652-2514 | support@roc-base.com | roc-base.com



Centro

Granite or quartz shower pan
Central drain

40/50-3636

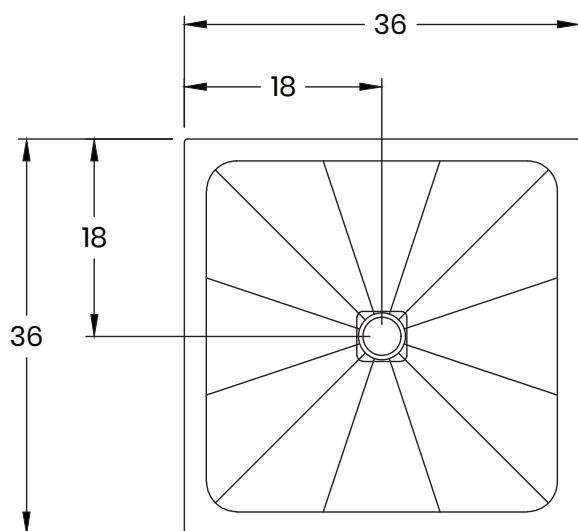

Dimensions

Length :	36" (914mm)
Width :	36" (914mm)
Thickness :	1 1/4" (30mm) (1mm to 3mm tolerance)
Weight :	135 LBS (60 KG)

Material

Base : Quartz or granite core

Drain cover : Stainless steel (with optional black finish)

Texture : Non-slip

Colors

Stock :



40-3636-07
Cambrian black



50-3636-HCL119
Tofino



50-3636-HRU609
Uptown Grey



50-3636-HBA252
Whistler



50-3636-HBA271
Drift

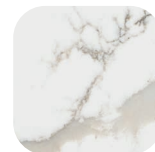

50-3636-HGB884
Calacatta Extra

* Other colors may be available upon request

Included

- Stainless steel drain grid**
(black finish optional)
- Tile flange
- Installation instructions

**Drain not included.

Features

- CSA B45.8/IAPMO Z403
- Non-slip surface
- Made from durable granite or quartz
- Easy maintenance and cleaning
- Customizable